

REV	APPROVED	DATE	REV TEXT

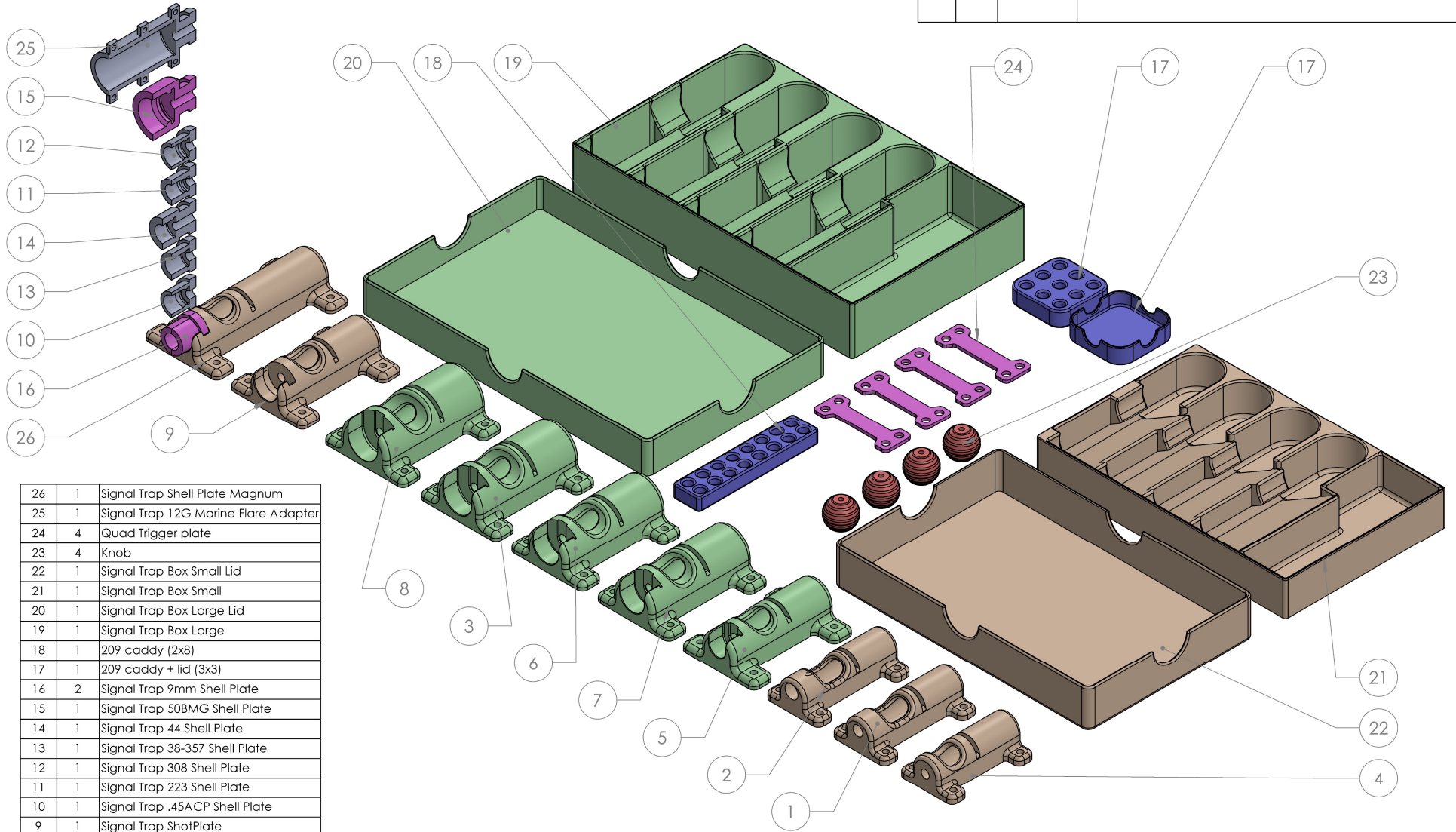

POS	QTY.	NAME
26	1	Signal Trap Shell Plate Magnum
25	1	Signal Trap 12G Marine Flare Adapter
24	4	Quad Trigger plate
23	4	Knob
22	1	Signal Trap Box Small Lid
21	1	Signal Trap Box Small
20	1	Signal Trap Box Large Lid
19	1	Signal Trap Box Large
18	1	209 caddy (2x8)
17	1	209 caddy + lid (3x3)
16	2	Signal Trap 9mm Shell Plate
15	1	Signal Trap 50BMG Shell Plate
14	1	Signal Trap 44 Shell Plate
13	1	Signal Trap 38-357 Shell Plate
12	1	Signal Trap 308 Shell Plate
11	1	Signal Trap 223 Shell Plate
10	1	Signal Trap .45ACP Shell Plate
9	1	Signal Trap ShotPlate
8	1	Signal Trap 10G
7	1	Signal Trap 20G
6	1	Signal Trap 16G
5	1	Signal Trap .410-45LC
4	1	Signal Trap 209
3	1	Signal Trap 12G
2	1	Signal Trap .27
1	1	Signal Trap .22

All dimensions in Millimeters!	MATERIAL	Printed + Steel	
	DESCRIPTION	BLC Signal Trap Collection aka. The Modular Thunder Clapper	
CREATED BY	DATE	SCALE	PART NO.
Not today fedboy!	2022	1:5	5318008
WEIGHT	DOC. NO:	SIZE	REV
	0-8-4	A3	

REV	APPROVED	DATE	REV TEXT

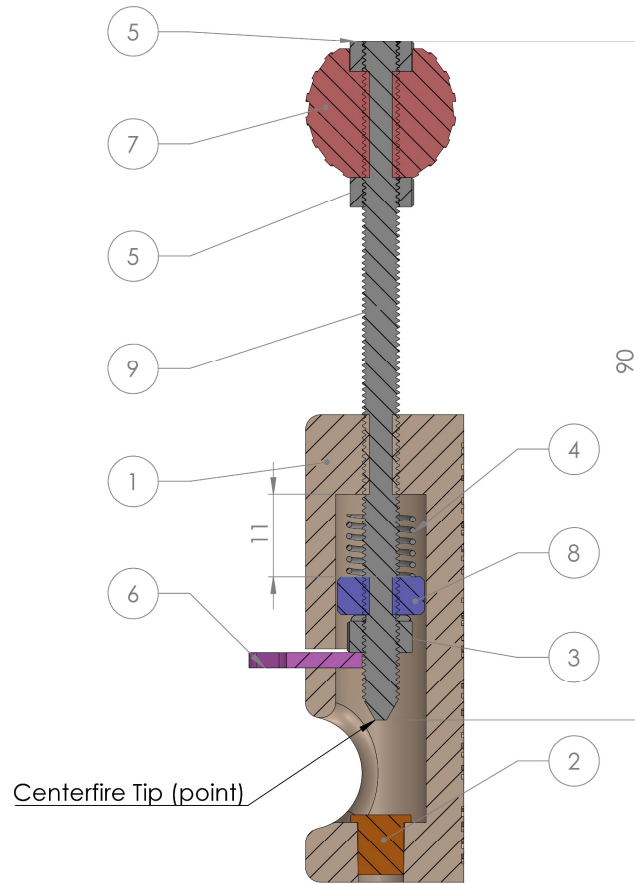
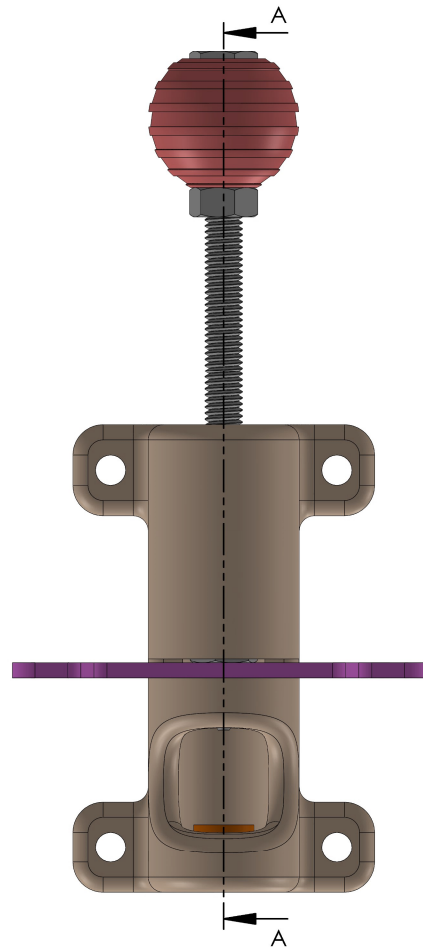

SECTION A-A
SCALE 1.5 : 1

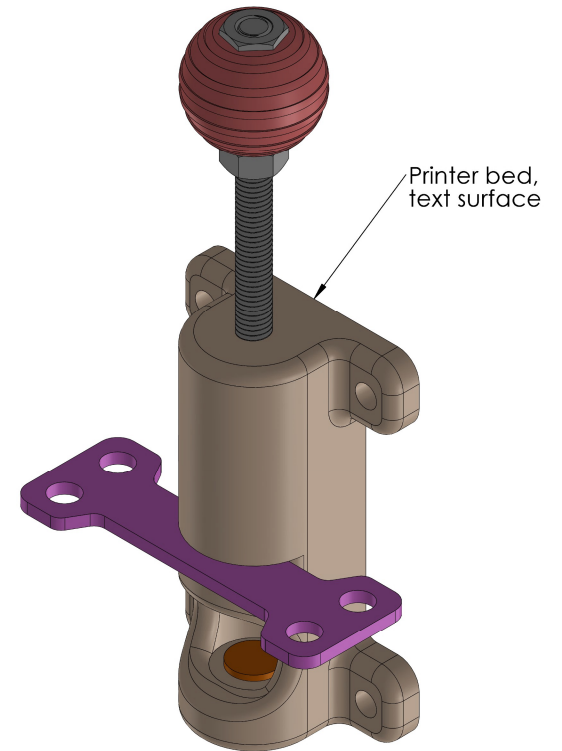

How to use Trap:

1. Pull back #7, slip #6 in slot, ease back #7.
2. Spin down #3 against #1 as a safety
3. Load #2 in chamber
4. Position loaded device where desired
5. Attach trip wire to #6
6. While holding #6, spin #3 all the way back up
7. Let go of #6, device charged and ready

POS	QTY.	Description	Dimension	Material	PartNo
9	1	Low-Strength Steel Threaded Rod	M5	Steel	98861A060
8	1	Strike washer		Printed	
7	1	Knob		Printed	
6	1	Quad Trigger plate		Printed	
5	2	Zinc-Plated Steel Hex Nut	M5	Steel	90591A146
4	1	Compression Spring	1.25 x 0.36 x 0.296 inch	Music-Wire Steel	9657K332
3	1	Medium-Strength Steel Nylon-Insert Locknut	M5	Steel	90576A104
2	1	209 Primer			
1	1	Signal Trap 209		Printed	

**All dimensions
in Millimeters!**

MATERIAL		Printed + Steel	
DESCRIPTION		Signal Trap 209	
SCALE	1:2	PART NO.	REV
CREATED BY	DATE	SIZE	
Not today fedboy!	2022	A3	5318008
WEIGHT	DOC. NO.	0-8-4	SHEET 2 OF 6

REV	APPROVED	DATE	REV TEXT

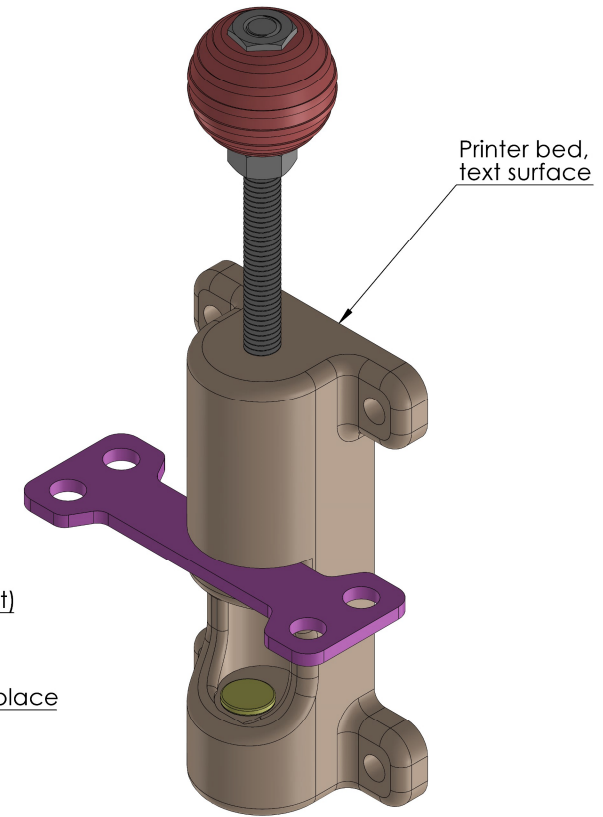
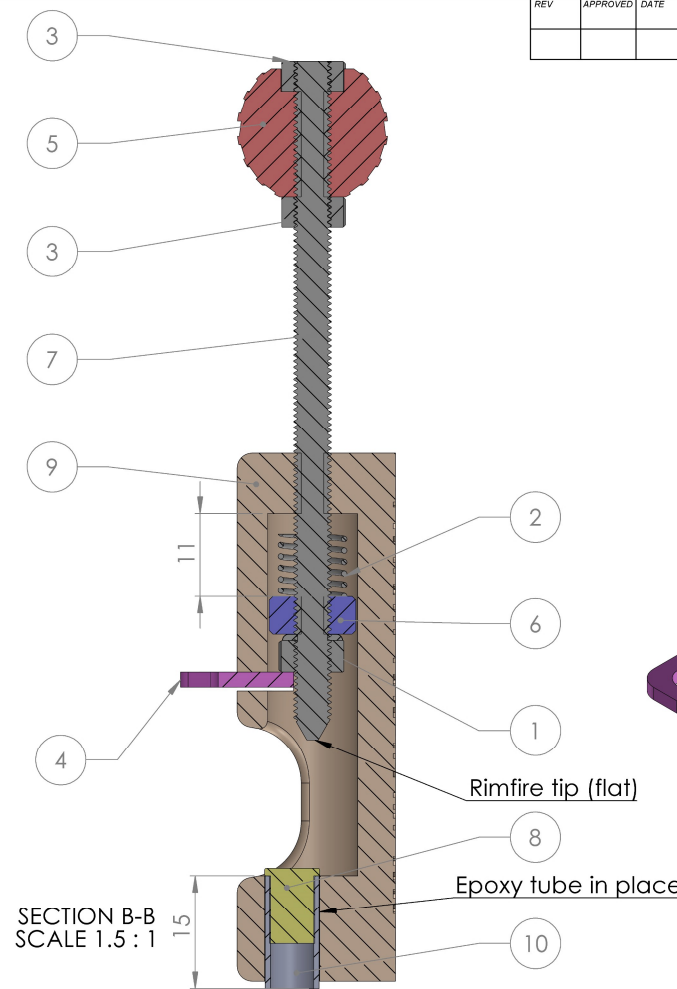
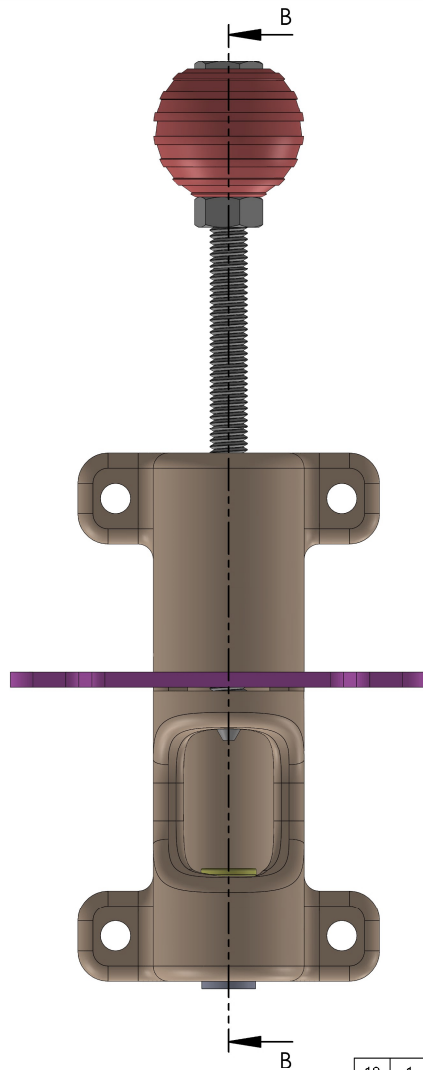

- How to use Trap:**
1. Pull back #5, slip #4 in slot, ease back #5.
 2. Spin down #3 against #9 as a safety
 3. Load #8 in #10
 4. Position loaded device where desired
 5. Attach trip wire to #4
 6. While holding #4, spin #3 all the way back up
 7. Let go of #4, device charged and ready

10	1	22LR tube	9/32 x 0.028 tube	Steel	
9	1	Signal Trap 22		Printed	
8	1	22LR Blank			
7	1	Low-Strength Steel Threaded Rod	M5	Steel	
6	1	Striker Washer		Printed	
5	1	Knob		Printed	
4	1	Quad Trigger Plate		Printed	
3	2	Zinc-Plated Steel Hex Nut	M5	Steel	90591A146
2	1	Compression Spring	1.25 x 0.36 x 0.296 inch	Music-Wire Steel	9657K332
1	1	Medium-Strength Steel Nylon-Insert Locknut	M5	Steel	90576A104
POS	QTY.	Description	Dimension	Material	PartNo

All dimensions in Millimeters!

CREATED BY		DATE	SCALE	PART NO.	REV
Not today fedboy!		2022	1:1	5318008	
WEIGHT		DOC. NO: 0-8-4		SHEET 3 OF 6	

MATERIAL: Printed + Steel

DESCRIPTION: Signal Trap 22

SCALE: 1:1 PART NO.: 5318008 REV:

CREATED BY: Not today fedboy! DATE: 2022 SIZE: A3

WEIGHT: DOC. NO: 0-8-4 SHEET 3 OF 6

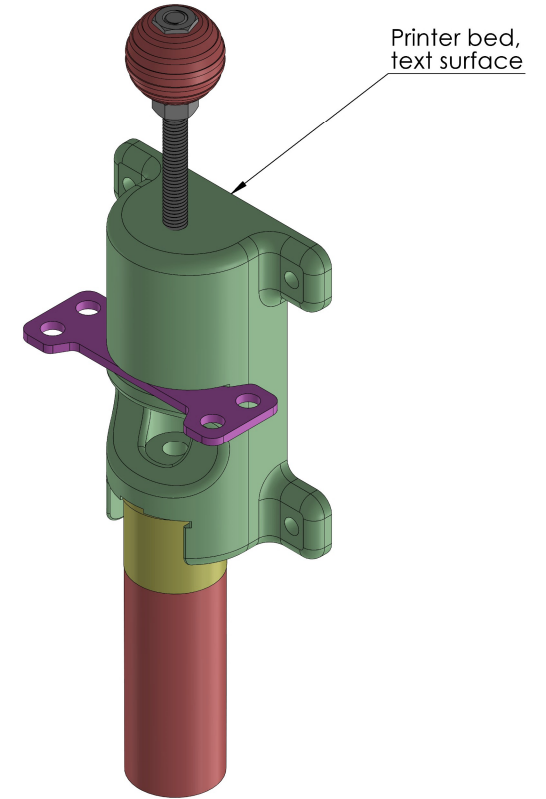
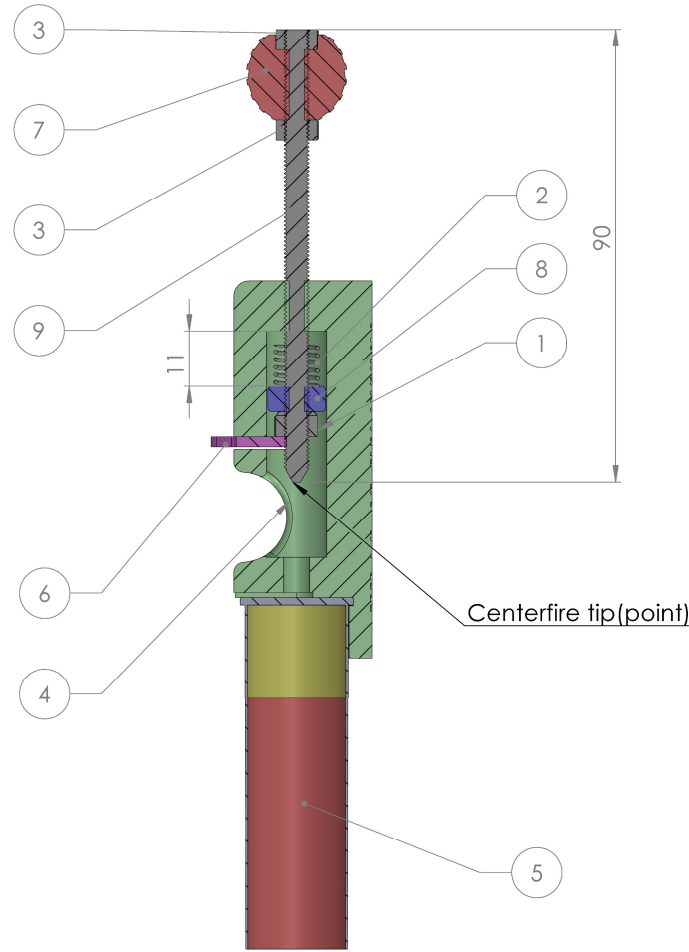
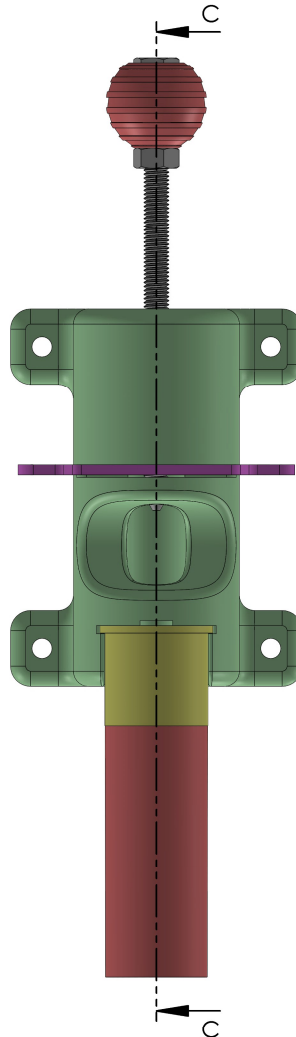

SECTION C-C

How to use Trap:

1. Pull back #7, slip #6 in slot, ease back #7.
2. Spin down #3 against #4 as a safety
3. Load #5 in chamber
4. Position loaded device where desired
5. Attach trip wire to #6
6. While holding #6, spin #3 all the way back up
7. Let go of #6, device charged and ready

POS	QTY.	Description	Dimension	Material	Part No
9	1	Low-Strength Steel Threaded Rod	M5	Steel	98861A060
8	1	Striker Washer		Printed	
7	1	Knob		Printed	
6	1	Quad Trigger plate		Printed	
5	1	12G Empty Shell w Primer		Printed	
4	1	Signal Trap 12G		Printed	
3	2	Zinc-Plated Steel Hex Nut	M5	Steel	90591A146
2	1	Compression Spring	1.25 x 0.36 x 0.296 inch	Music-Wire Steel	9657K332
1	1	Medium-Strength Steel Nylon-Insert Locknut	M5	Steel	90576A104

**All dimensions
in Millimeters!**

MATERIAL Printed + Steel			
DESCRIPTION Signal Trap 12G			
SCALE 1:1	PART NO. 5318008	REV	
CREATED BY Not today fedboy!	DATE 2022	SIZE A3	
WEIGHT		DOC. NO.: 0-8-4	SHEET 4 OF 6

REV	APPROVED	DATE	REV TEXT

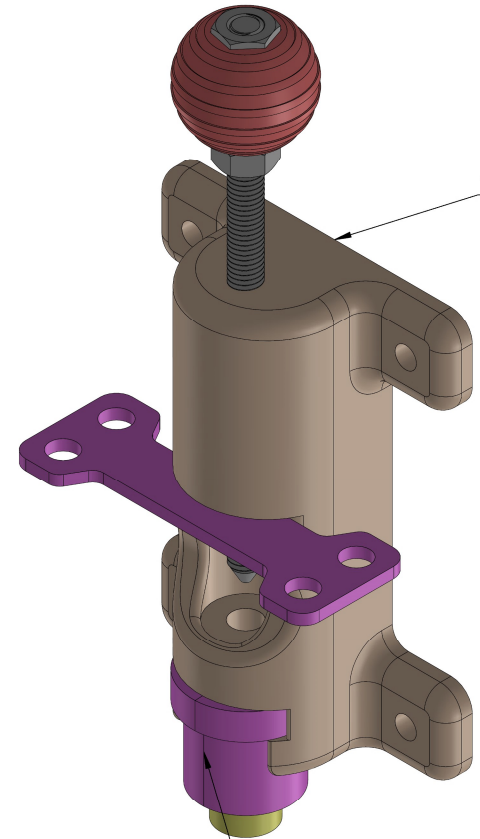
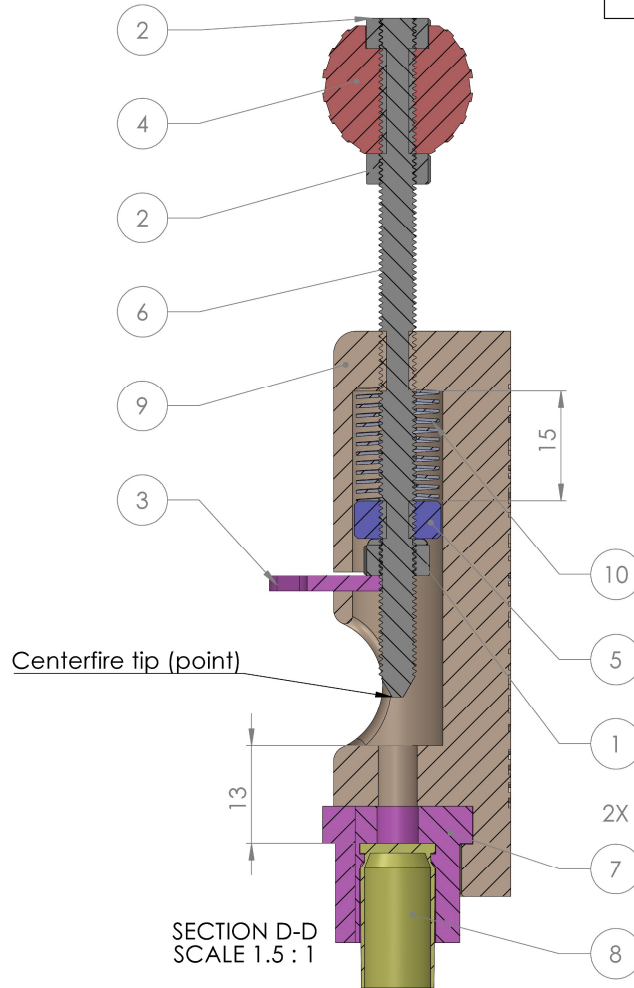
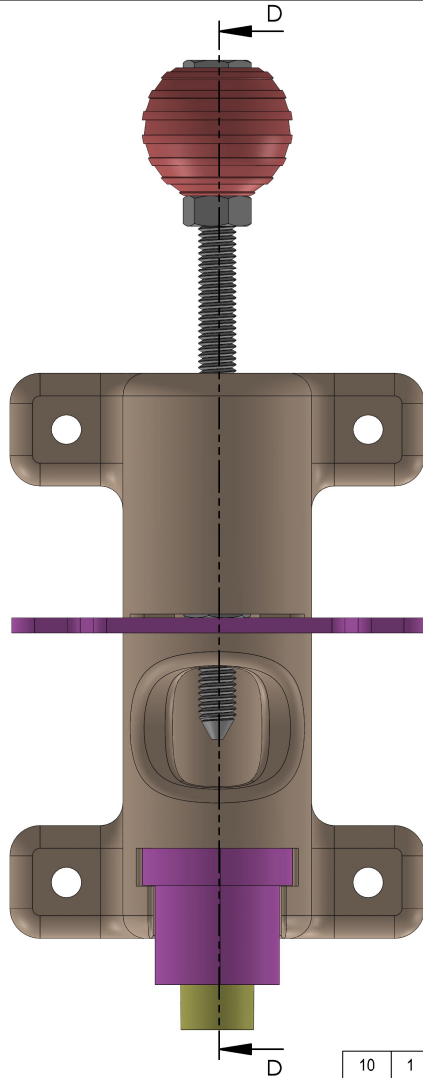

- How to use Trap:**
1. Pull back #4, slip #3 in slot, ease back #4.
 2. Spin down #2 against #9 as a safety
 3. Place 2x #7 around #8
 4. Load #7+#9 into #9 with seam perpendicular
 5. Position loaded device were desired
 6. Attach trip wire to #3
 7. While holding #3, spin #2 all the way back up
 8. Let go of #3, device charged and ready

POS	QTY.	Description	Dimension	Material	PartNo
10	1	Glock Spring	Cut +/-40mm long		
9	1	Trap Shell Plate Regular		Printed	
8	1	9mm Empty Shell w Primer			
7	2	Shell Plate 9mm			
6	1	Low-Strength Steel Threaded Rod	M5	Steel	98861A060
5	1	Striker Washer		Printed	
4	1	Knob		Printed	
3	1	Quad Trigger Plate		Printed	
2	2	Zinc-Plated Steel Hex Nut	M5	Steel	90591A146
1	1	Medium-Strength Steel Nylon-Insert Locknut	M5	Steel	90576A104

All dimensions in Millimeters!	MATERIAL	Printed + Steel	
	DESCRIPTION	Signal Trap Shell Plate Regular	
	SCALE	1:1	PART NO.
CREATED BY	DATE	SIZE	
Not today fedboy!	2022	A3	5318008
WEIGHT	DOC. NO.	SHEET 5 OF 6	
	0-8-4		

REV	APPROVED	DATE	REV TEXT

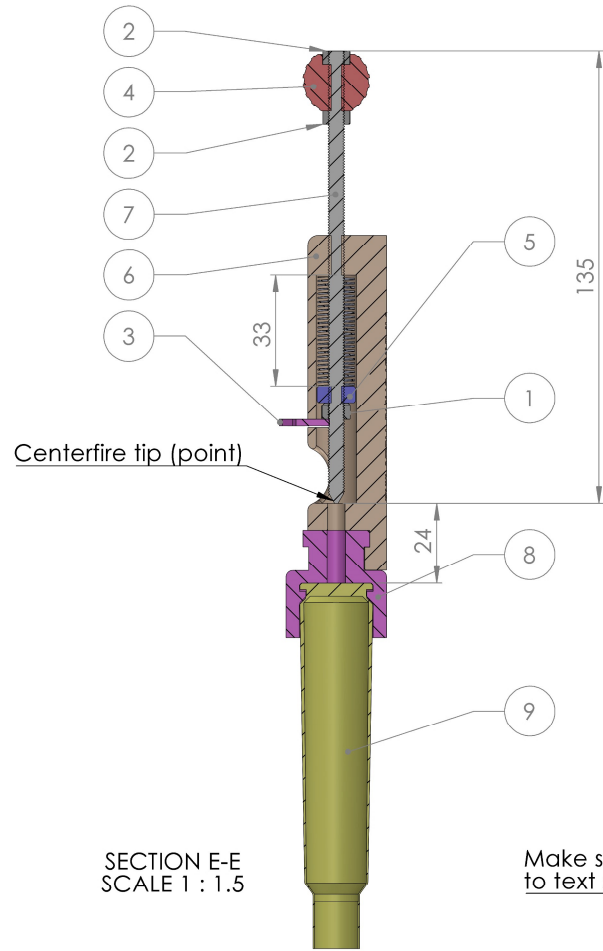
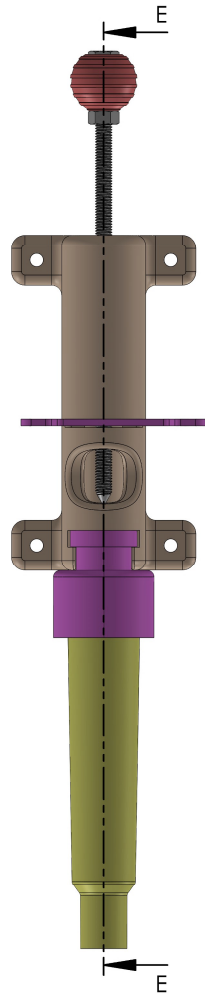

SECTION E-E
SCALE 1 : 1.5

Make sure split is perpendicular
to text surface when loading

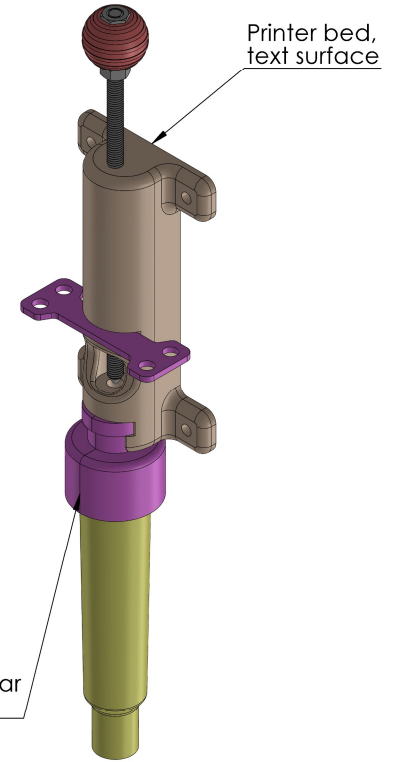

- How to use Trap:**
1. Pull back #4, slip #3 in slot, ease back #4.
 2. Spin down #2 against #6 as a safety
 3. Place 2x #9 around #10
 4. Load #9+#10 into #6 with seam perpendicular
 5. Position loaded device were desired
 6. Attach trip wire to #3
 7. While holding #3, spin #2 all the way back up
 8. Let go of #3, device charged and ready

10	1	glock spring	Cut ot +/-60mm		
9	1	.50BMG Empty Shell w Primer			
8	2	.50BMG Shell Plate		Printed	
7	1	Low-Strength Zinc-Plated Steel Threaded Rod	M5	Steel	94595A217
6	1	Signal Trap Shell Plate Magnum		Printed	
5	1	Striker Washer		Printed	
4	1	Knob		Printed	
3	1	Quad Trigger Plate		Printed	
2	2	Zinc-Plated Steel Hex Nut	M5	Steel	90591A146
1	1	Medium-Strength Steel Nylon-Insert Locknut	M5	Steel	90576A104
POS	QTY.	Description	Dimension	Material	PartNo

All dimensions in Millimeters!	MATERIAL Printed + Steel			
	DESCRIPTION Signal Trap Shell Plate Magnum			
	CREATED BY Not today fedboy!	DATE 2022	SCALE 1:1	PART NO. 5318008
WEIGHT		DOC. NO.: 0-8-4		SHEET 6 OF 6